

# HILLIER & WILSON



Masefield Road, Thatcham, RG18 3AF



## Masefield Road, Thatcham

A well-presented three bedroom family home located in the popular Whitelands development of Thatcham. The property is offered with no onward chain and benefits from good sized living accommodation, gas central heating and uPVC double glazing. The ground floor accommodation promises entrance hall, storage cupboard, dining room, kitchen and sitting room. Upstairs there are three double bedrooms and a family bathroom with separate shower. Externally there is an attractive rear garden which is mainly laid to lawn with a mature tree/hedge border, flower beds and a patio seating area. Masefield Road is ideally located just a short drive away from Thatcham town centre and mainline railway station which provides regular direct links to London Paddington taking less than an hour. The market town of Newbury is also a short drive away and there are excellent road links nearby including the A4, A34 and M4 motorway.







- THREE BEDROOM FAMILY HOME
  - PRESENTED IN GOOD CONDITION
- LOCATED IN THE POPULAR WHITELANDS DEVELOPMENT
- NORTH WESTERLY FACING GARDEN
- CLOSE TO THATCHAM TOWN CENTRE
  - NO ONWARD CHAIN

Services:

Mains services are connected

EPC: Rating D

Full results can be sent on request

Council Tax:

Band C





# Masefield Road Thatcham

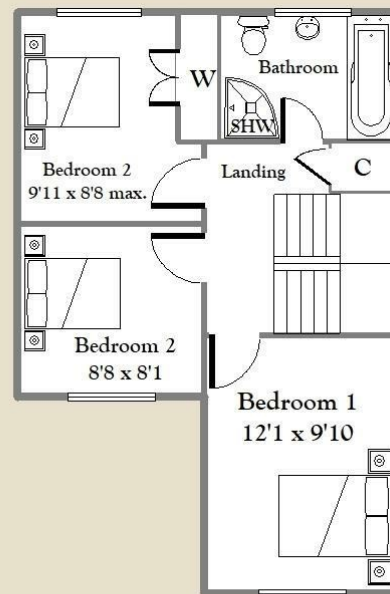
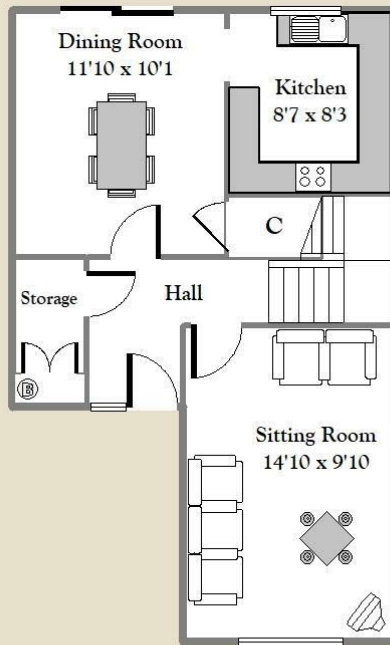
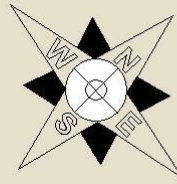

APPROX.GROSS INTERNAL FLOOR AREA 910 sq.ft (84 sq.m)  
For identification only - Not to scale - Hillier & Wilson LTD

HILLIER & WILSON



Hillier & Wilson wish to inform prospective purchasers that we have listed the details of this property as a general guide and in good faith. We have not carried out a detailed survey nor tested the services, appliances or specific fittings. Any reference to alterations does not mean that any planning permission, building regulation or other consent has been obtained. Investigations must be made by buyer's solicitor. Room sizes should not be relied upon for carpets and furnishings. Fixtures & fittings are excluded from the property unless stated in the sales particulars.

HILLIER & WILSON

Bartholomew House  
64 Bartholomew Street  
Newbury  
Berkshire  
RG14 7BE